



DO NOT SCALE

NOTES:

- 1. REFER TO WSP DRAWING 11500611/06 FOR CROSS SECTION DETAILS
- 2. THIS PLAN WAS PRODUCED USING DRAWINGS REF: 2048 (SK) 21 BY LSI ARCHITECTS DATED 22.11.06 AND RANDALL SURVEYS CRT DRAWING (DATED 20/12/1995), LINEARITY SECTIONS (14/07/05) AND EA RIVER CAM CROSS SECTIONS (OCTOBER 1990).
- 3. ALL LEVELS ARE REFERENCED TO ORDNANCE DATUM

KEY:
 CROSS SECTION LOCATIONS
 PROPOSED CONTOURS

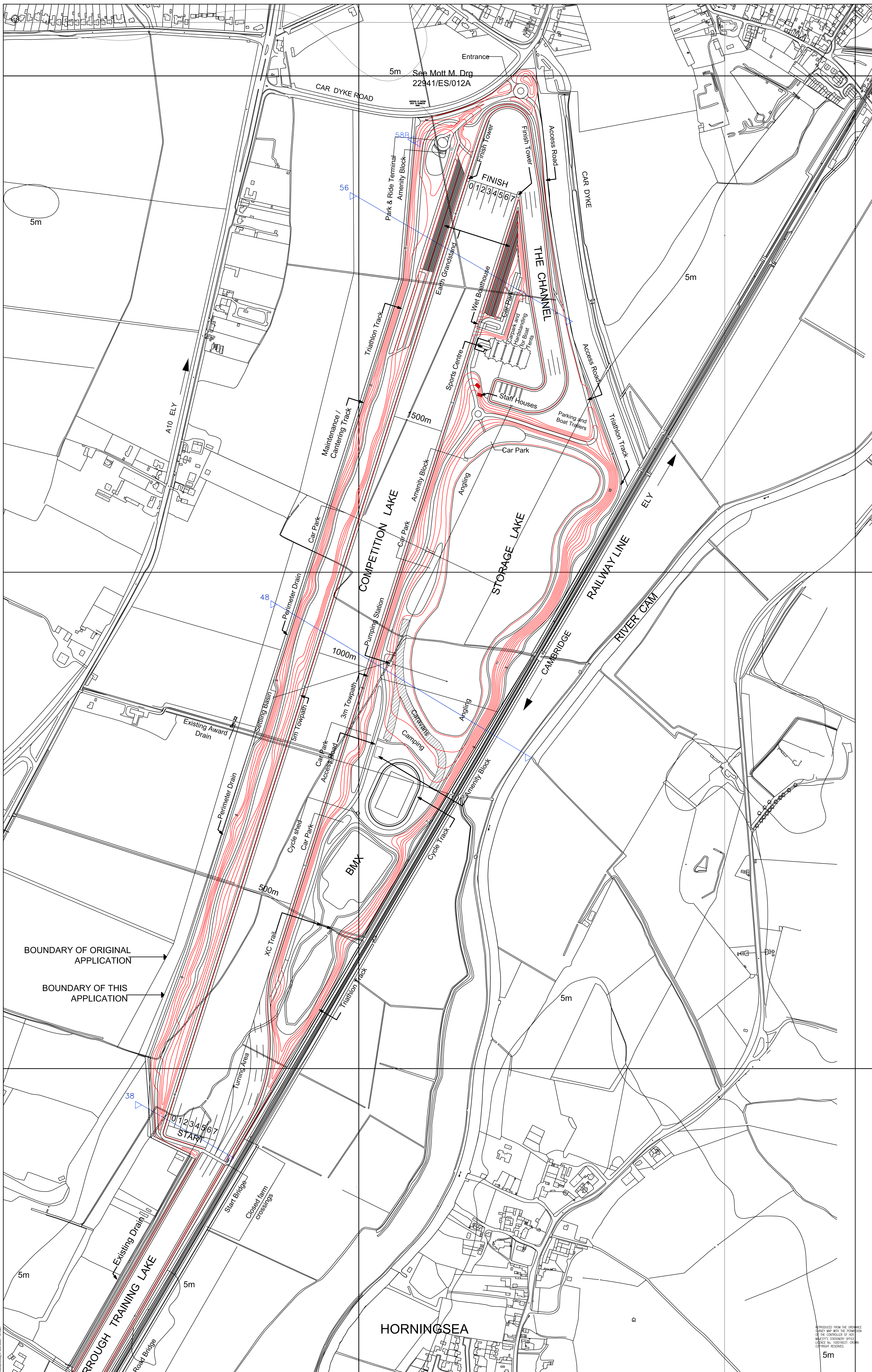

BOUNDARY OF ORIGINAL APPLICATION
 BOUNDARY OF THIS APPLICATION

HORNINGSEA

PRODUCED FROM THE ORDNANCE SURVEY MAP WITH THE PERMISSION OF THE CONTROLLER OF HER MAJESTY'S STATIONERY OFFICE. © 1999 HER MAJESTY'S STATIONERY OFFICE. ALL RIGHTS RESERVED.

REV	DATE	BY	DESCRIPTION	CHK	APP
A	20/11/06	SK	Initial Issue	KA	SP

FOR INFORMATION ONLY

WSP
 WSP House, The Chase, John Tate Road
 Fobbes Business Park, Harford, SO13 7JN
 Tel: +44 (0)1992 526000 Fax: +44 (0)1992 526001
 http://www.wspgroup.com

CLIENT: CAMBRIDGE SPORT LAKES TRUST
 PROJECT: CAMBRIDGE SPORT LAKES
 ARCHITECT: LSI
 TITLE: PROPOSED GROUND CONTOURS

SCALE: 1:2500
 CHECKED: KA
 APPROVED: SP
 DATEFILE: Xsections.dwg
 DESIGN/DATE: SEK
 DATE: 28.11.06
 PROJECT NO: 11500611
 DRAWING NO: 07
 REV: A

© WSP Group plc